

LEGEND

- EXISTING GREENWAYS
- - - EXISTING MULTI-USE CORRIDOR
- - - EXISTING SIDEWALKS
- EXISTING BIKE LANES
- DETAILED GREENWAY CORRIDOR STUDIES
- PLANNED GREENWAY CORRIDORS
- PROPOSED SURROUNDING JURISDICTIONS' GREENWAYS
- - - PROPOSED MULTI-USE CORRIDOR
- - - PROPOSED SIDEWALKS
- FUNDED PROJECTS
- ☀ INTERSECTION NEEDS IMPROVEMENT
- 🎓 SCHOOL
- 🚏 TRANSIT STOP
- 🚂 RAILROAD
- INTERSTATE
- MAJOR ROADWAY
- SURROUNDING JURISDICTIONS' GREENWAYS
- 🌊 LAKES AND PONDS
- 🌿 WETLANDS
- 🌳 EXISTING PARKS
- 🌱 2030 LAND USE PLAN OPEN SPACE
- 🏘 PLANNING AREA BOUNDARY

- MULTI-USE CORRIDORS**
1. NC 73/CHURCH STREET/CORBAN AVENUE
 2. POPLAR TENT ROAD/MCGILL AVENUE/BUFFALO AVENUE
 3. HARRIS ROAD
 4. ODELL SCHOOL ROAD
 5. COX MILL ROAD
 6. BRITTON SMITH BOULEVARD/CONCORD MILLS BOULEVARD/CHRISTENBURY PARKWAY
 7. PITTS SCHOOL ROAD
 8. WEDDINGTON ROAD/ROCK HILL CHURCH ROAD
 9. GEORGE W LILES PARKWAY
 10. ROBERTA ROAD
 11. OLD CHARLOTTE ROAD
 12. WILSHIRE AVENUE
 13. HIGHWAY 601/WARREN C. COLEMAN BOULEVARD
 14. BRANCHVIEW DRIVE (NC 3)
 15. ZION CHURCH ROAD/LINCOLN STREET
 16. LAKE CONCORD ROAD
 17. FLOWE STORE ROAD
 18. MIAMI CHURCH ROAD
 19. COLD SPRINGS ROAD
 20. STOUGH ROAD

- INTERSECTION NEEDS IMPROVEMENT**
1. POPLAR TENT ROAD & HARRIS ROAD
 2. POPLAR TENT ROAD & COX MILL ROAD
 3. POPLAR TENT ROAD & DERTIA ROAD
 4. POPLAR TENT ROAD & PITTS SCHOOL ROAD
 5. WEDDINGTON ROAD & PITTS SCHOOL ROAD
 6. DERTIA ROAD & CONCORD MILLS BOULEVARD
 7. INTERSTATE 85 & BRITTON SMITH BOULEVARD
 8. BRITTON SMITH BOULEVARD & US-29
 9. POPLAR TENT ROAD & GEORGE W LILES PARKWAY
 10. GEORGE W LILES PARKWAY & WEDDINGTON ROAD
 11. CONCORD PARKWAY & PITTS SCHOOL ROAD
 12. CONCORD PARKWAY & GEORGE W LILES PARKWAY
 13. NC HIGHWAY 49 & OLD CHARLOTTE ROAD
 14. BRANCHVIEW DRIVE & BURRAGE ROAD
 - 15A. CONCORD PARKWAY & CHURCH STREET
 - 15B. DAVIDSON HIGHWAY & CONCORD PARKWAY
 16. MIRAMAR STREET & BRANCHVIEW DRIVE
 17. BROOKWOOD AVENUE & BRANCHVIEW DRIVE
 18. MCGILL AVENUE & BUFFALO AVENUE
 19. BRANCHVIEW DRIVE & CABARRUS AVENUE
 20. POPLAR TENT ROAD & CONCORD PARKWAY
 21. CONCORD PARKWAY & CABARRUS AVENUE
 22. UNION STREET & CABARRUS AVENUE
 23. BRANCHVIEW DRIVE & CORBAN AVENUE
 24. UNION STREET SOUTH & WILSHIRE AVENUE
 25. UNION STREET SOUTH & BRANCHVIEW DRIVE
 26. ROBERTA ROAD & GEORGE W LILES PARKWAY/STOUGH ROAD

- GREENWAY CORRIDORS**
1. ACADEMY BRANCH (VILLAGE GREENWAY)
 2. ROCKY RIVER (HECTOR H. HENRY)
 3. CODDLE CREEK
 4. IRISH BUFFALO CREEK
 5. THREE-MILE BRANCH (HAROLD B. MCEACHERN)
 6. CLARKE CREEK (NEW)
 7. STRICKER BRANCH (NEW)
 8. COLD WATER CREEK (NEW)
 9. REEDY CREEK (NEW)
 10. WOLF MEADOW BRANCH
 11. ROCKY RIVER TRIBUTARY (NEW)
 12. CODDLE CREEK TRIBUTARY (NEW)
 13. NC/ROOTSMEAD RAIL SPUR (NEW)
 14. GREAT PHILADELPHIA WAGON ROAD (NEW)

NOTE:
 THE MULTI-USE CORRIDOR LINES THAT ARE LOCATED ON A SPECIFIC SIDE OF THE ROAD DENOTES A RECOMMENDED OR PRE-DETERMINED LOCATION. IF THE MULTI-USE CORRIDOR LINE IS LOCATED ALONG THE CENTERLINE OF THE ROAD A SPECIFIC LOCATION(S) WILL BE DETERMINED UPON MORE DETAILED ANALYSIS OF THE CORRIDOR DURING SUBSEQUENT PHASES OF CORRIDOR AND FEASIBILITY STUDIES. THE CITY MUST EVALUATE THESE CORRIDORS ON A CASE BY CASE BASIS TO DETERMINE THE APPROXIMATE TREATMENT BASED ON CITIZEN INPUT, ROAD TYPE/ SPEED LIMIT, NUMBER OF TRAVEL LANES, VOLUME OF VEHICULAR TRAFFIC, ETC.

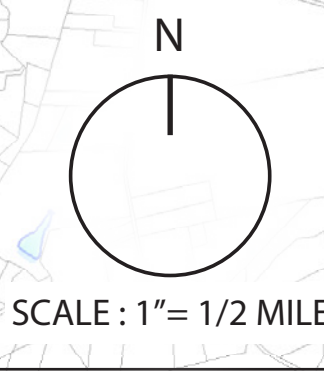

CONCORD CONNECTIVITY PLAN
 OVERALL CONNECTIVITY SYSTEM